

RIV 5146

Water meter inlet ball valve M/F
 with telescopic fitting for meter
 full bore
 Extra-Lock brass tamperproof butterfly handle

Tech drawings and tables

DN	Code	Ø	F	H	L	R	S	PNKGP/box	
1/2"x3/4"	025146000187	15	17	51,5	53	14	91	40	10
3/4"x1"	025146000230	20	17	58,5	58	14	104	40	10

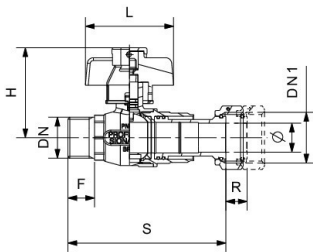

Technical data

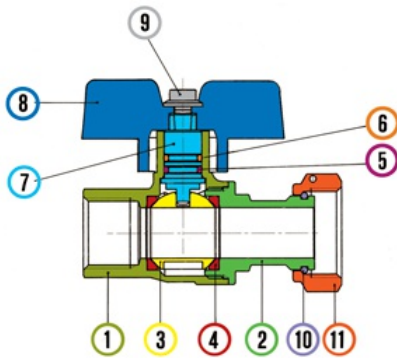

Materials			
1	Body	Brass	Nickel-plated
2	Body end	Brass	Nickel-plated
3	Ball	Brass	Chrome-plated
4	Seats	PTFE	
5	O-Ring	FKM	
6	O-Ring	NBR	
7	Stem	Brass	
8	Butterfly handle	Aluminium	Green
9	Screw	Steel	Zinc-plated
10	Seeger	Stainless Steel	Nickel-plated
11	Swivel nut	Brass	

Connections	Female ISO 7/1Rp (parallel), Male ISO 7/1R (tapered), screwed ring ISO 228/1
Limit	-20°C (without liquid) +110°C
Notes	The max.working pressure (PN) means at a room temperature of about 23°C.

Pressure Loss Chart

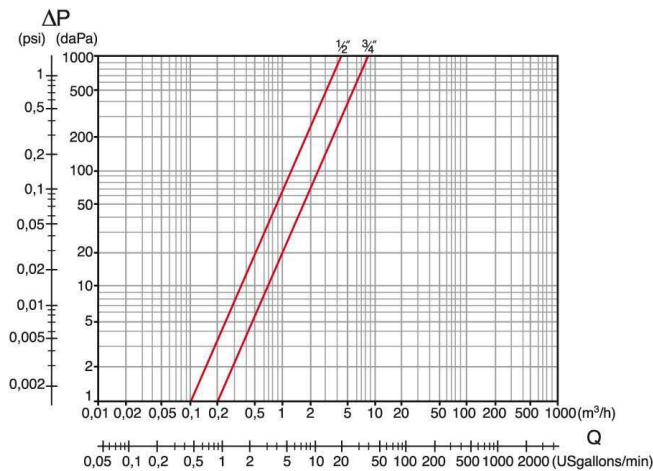

Temperature/Pressure

